

27-SEP-2013 14:10
S:\Proj\Wgmt\Landscape_Contracts\33920.3.4_US15-501_MtPisgah_Lee Co\US 1-15501 split & Mt Pisgah plans.dgn
jstoder

Project: US 421 @ Mt. Pisgah Ch. Rd. (sanford, nc)
& us 1 & US 15-501 Split (tRAMWAY, nc)



PROPOSED HIGHWAY LANDSCAPE DEVELOPMENT PROJECT



T.I.P. #	STATE PROJECT W.B.S. #	SHEET #	SHEET # TOTAL
	33920.3.4	L1	4
FED. PROJ. #	DESCRIPTION		DIVISION
	landscape		8

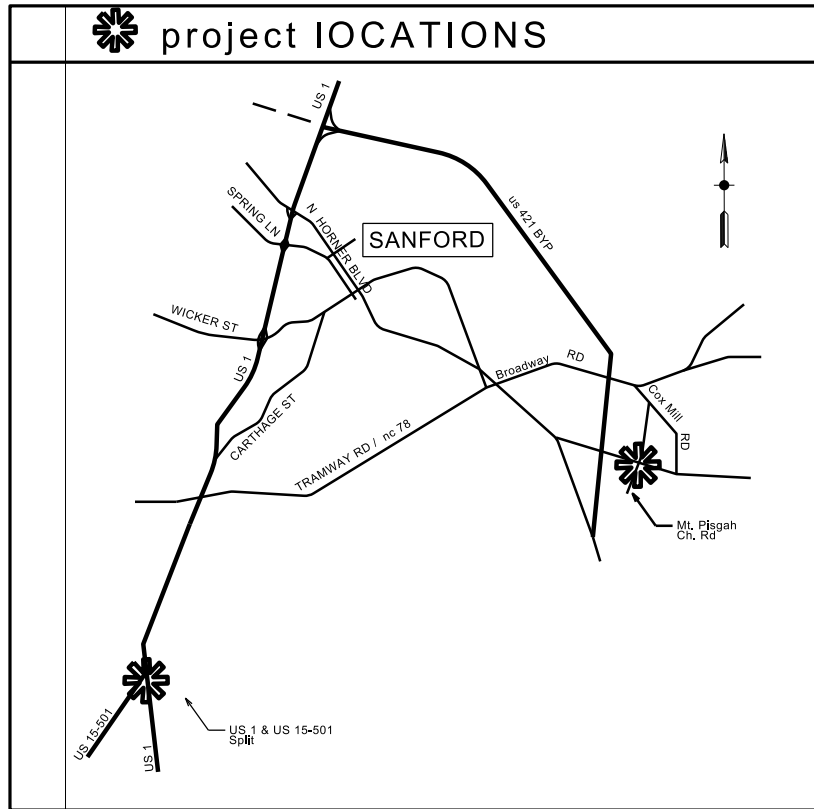
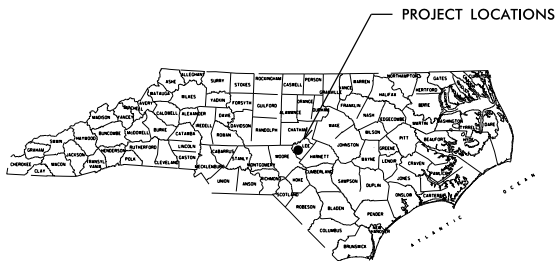

summary of project quantities

QTY.	KEY	BOTANICAL NAME	COMMON NAME	FURNISH	REMARKS
Deciduous Trees					
7	CC	<i>Cercis canadensis</i>	E. Redbud	6', B & B	As Shown
6	CF	<i>Cornus florida</i>	Flowering Dogwood	6-8', B & B	As Shown
6	CV	<i>Chionathus virginicus</i>	White Fringetree	5', B & B	As Shown
3	IF	<i>Ilex x attenuata 'Fosteri'</i>	Foster's Holly #2	6', B&B	As Shown
55	INR	<i>Ilex x 'Nellie R Stevens'</i>	Nellie R Stevens Holly	6', B&B	As Shown
5	LM	<i>Lagerstroemia indica 'Muskogee'</i>	Muskogee Crape Myrtle	10'-12', B & B	Min. 2" Cal.
2	LP	<i>Lagerstroemia indica 'Potomac'</i>	Potomac Crape Myrtle	10'-12', B & B	Min. 2" Cal.
28	PP	<i>Pinus palustris</i>	Long Leaf Pine	8'-10', B&B	As Shown
14	PY	<i>Prunus x yedoensis 'Yoshino'</i>	Yoshino Cherry	10'-12', B & B	As Shown
3	QN	<i>Quercus nuttalli</i>	Nuttall Oak	10'-12', 2 1/2" cal., B & B	Min. 2" Cal.
Shrubs					
143	RR	<i>Rosa 'Radko'</i>	Dbl. Knockout Rose (Red)	15-18", #3 Cont.	3' O.C.
Ornamental Grasses and Perennial Plants					
74	MC	<i>Muhlenbergia capillaris</i>	Pink Muhly Grass	#1 Cont	2' O.C.
198	PHM	<i>Panicum virgatum 'Heavy Metal'</i>	Heavy Metal Switchgrass	#1 Cont	3' O.C.
Descriptions					
350	CY	Mulch			
50	MG	Water for Planting			
1	LS	Plant Bed Cleanup			
1,750	SY	Pre-emergent Herbicidal Treatment			
3,100	SY	Post-emergent Herbicidal Treatment			

CONVENTIONAL SYMBOLS

County Line	-----
City or Town Line	-----
Exist. Right of Way Line Marker	-----▲-----
Prop. Right of Way Line Marker (By Others)	-----▲-----
Prop Right of Way Line Marker (By Contract)	-----▲-----
Exist. Control of Access Line	-----○-----
Prop. Control of Access Line	-----○-----
Property Line	-----○-----
Easement Line	-----○-----
Slope Stake Line	-----○-----
Exist. Fence	-----+-----
Prop. Woven Wire Fence	-----○-----
Prop. Chain Link Fence	-----○-----
Exist. Road	=====
Prop. Road	=====
Guardrail	-----+-----
Survey Line	-----+-----
Denotes Line Equality	-----○-----
Bridge	=====
Culvert	=====
Railroad	-----+-----
Woods	-----+-----
Exist. Telephone Pole	-----○-----
Prop. Telephone Pole	-----○-----
Tower Pole and Line	-----○-----
Exist. Power Pole	-----○-----
Prop. Power Pole	-----○-----
Sanitary Sewer Line	-----+-----
Water Line	-----+-----
Gas Line	-----+-----
Picnic Shelter	-----+-----
Regeneration	-----+-----
Reforestation	-----+-----

INDEX OF SHEETS:

- L1 ... TITLE SHEET,
SUMMARY OF QUANTITIES
L 2... PLANTING DETAILS
L 3... US 1 & US 15-501 Split
Landscape Plan
L 4... US 421 @ Mt. Pisgah Ch. Rd
Landscape Plan

PREPARED BY: BK DATE: SEPT/2013

REVISIONS

DATE	DESCRIPTION

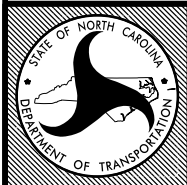

STATE OF
NORTH CAROLINA
DEPARTMENT OF TRANSPORTATION

LOCATION: US 421 @ Mt. Pisgah Ch. Rd. (Sanford, NC) &
US 1 & US 15-501 Split (Tramway, NC)

TYPE of WORK: Landscape Planting

COUNTY: lee

2004 American Standard for Nursery Stock

2012 NCDOT STANDARD SPECIFICATIONS

PREPARED IN THE OFFICE OF:
NCDOT- ROADSIDE ENVIRONMENTAL UNIT
LANDSCAPE DESIGN & DEVELOPMENT SECTION
1557 MAIL SERVICE CENTER
RALEIGH NC 27699 919-707-2935

27-SEP-2013 16:10
S:\Prof\mnt\landscape\33920.3.4_US15-501_mfPisgah_Lee Co\US 1-15501 split & Mt Pisgah plans.dgn
jstoder AT D8CAD-257160

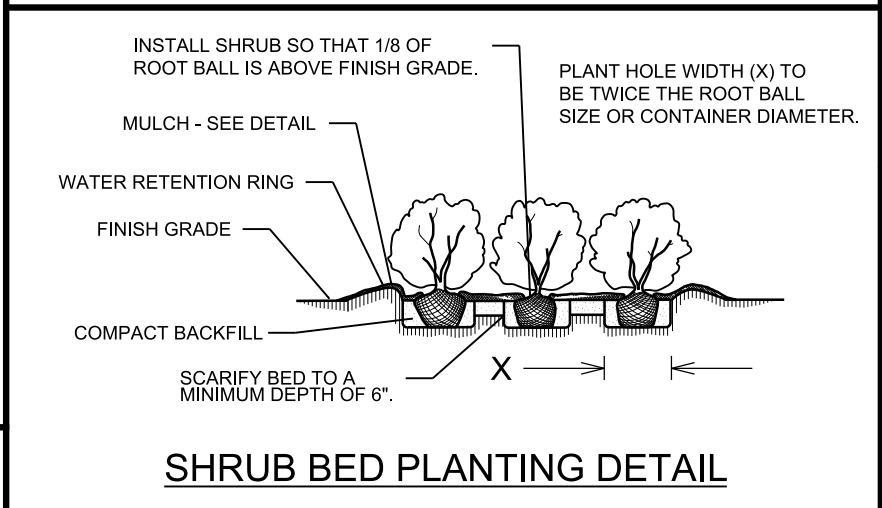
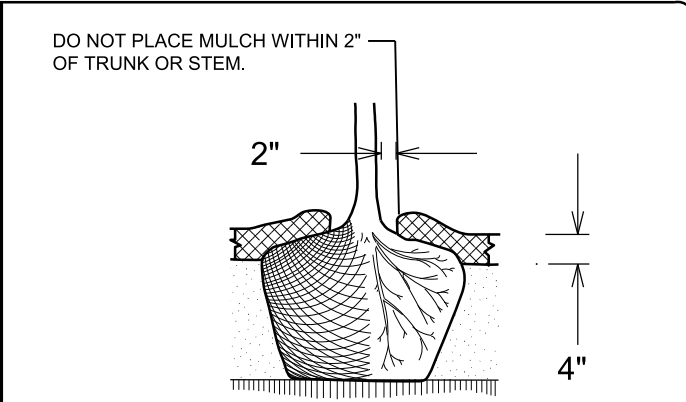
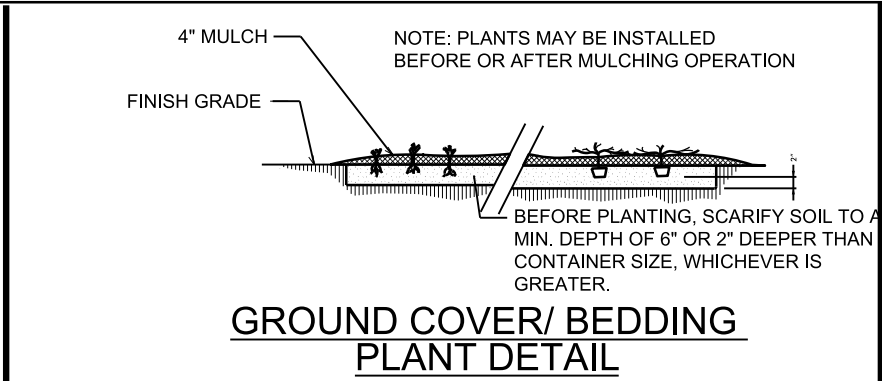
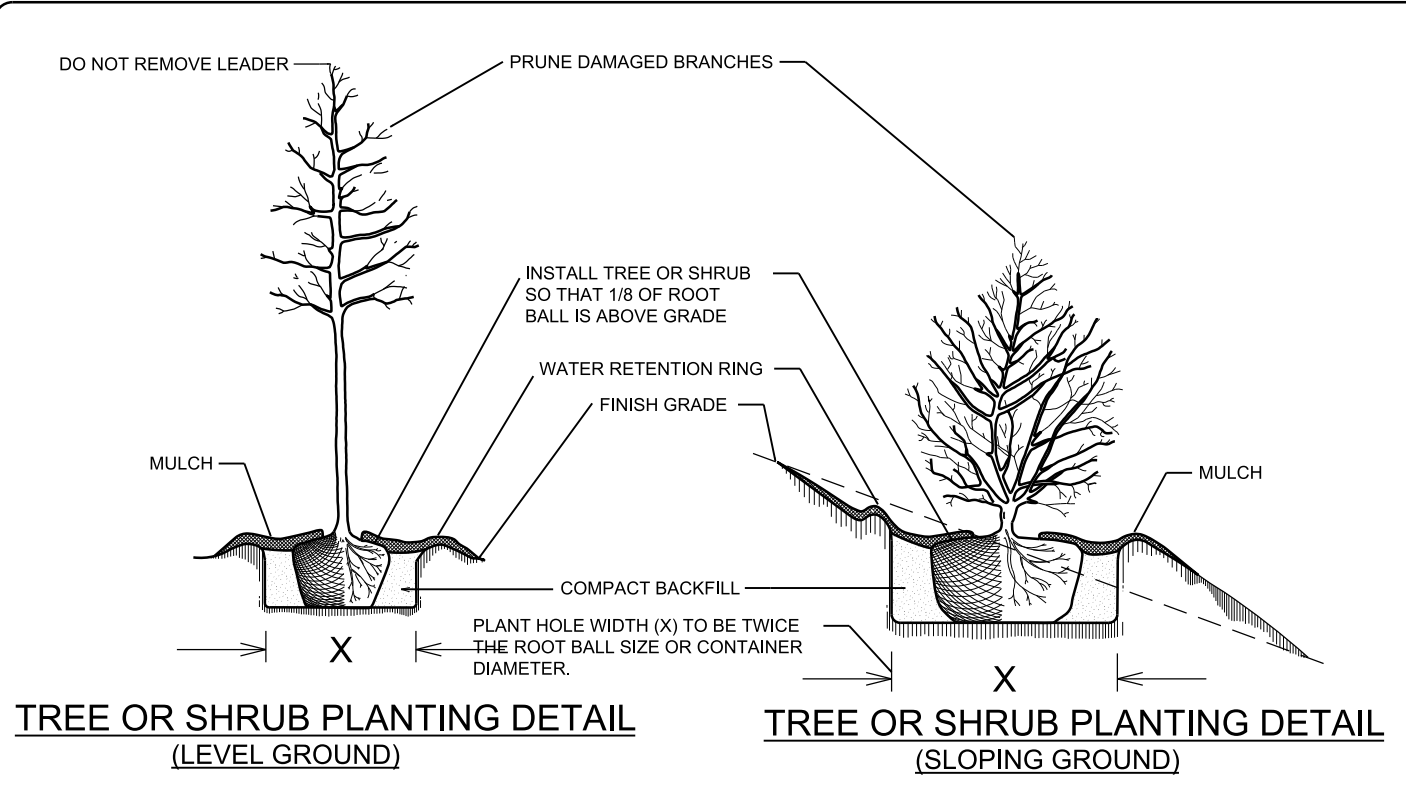

- NOTES:**
- SCHEDULE FOR PLANT HOLE SIZE: PLANT HOLE WIDTH (X) TO BE TWICE THE ROOT BALL SIZE OR CONTAINER DIAMETER.
 - SEE STANDARD SPECIFICATIONS FOR PLANT BED FUMIGATION AND HERBICIDAL TREATMENT.
 - APPLY FERTILIZER AT PLANTING TIME IN THE FORM OF A SLOW RELEASE PELLET OR TABLET. APPLY AT RATE RECOMMENDED BY MANUFACTURER. BOTH RATE AND FORMULATION MUST BE APPROVED BY FIELD ENGINEER PRIOR TO APPLICATION.
 - REMOVE WIRE BASKET AND FOLD BURLAP BACK FROM TOP OF ROOT BALL BEFORE BACKFILLING IS COMPLETE.
 - ALL PRUNING TO FOLLOW STANDARD ARBORICULTURAL PRACTICES AS SPECIFIED BY INTERNATIONAL SOCIETY OF ARBORICULTURE.
 - DO NOT ATTEMPT TO STRAIGHTEN A TREE THAT HAS BEEN PLANTED AT AN ANGLE WITH THE USE OF STAKING OR GUYING. DIG TREE AND REPLANT TO UPRIGHT POSITION.

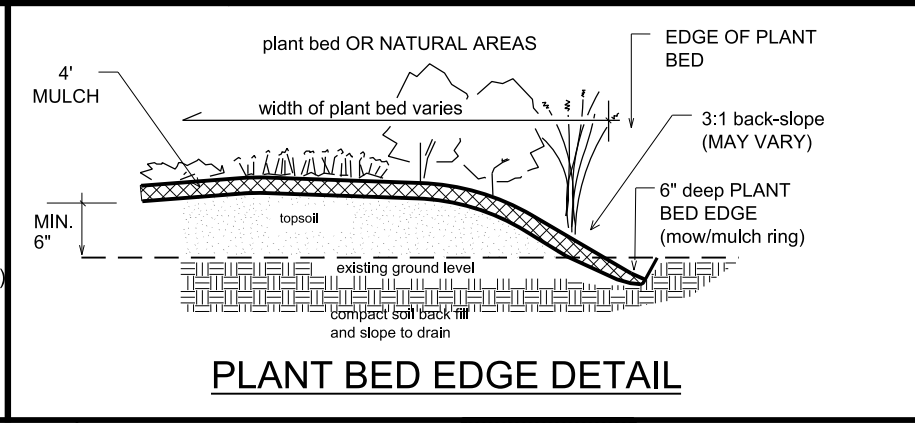
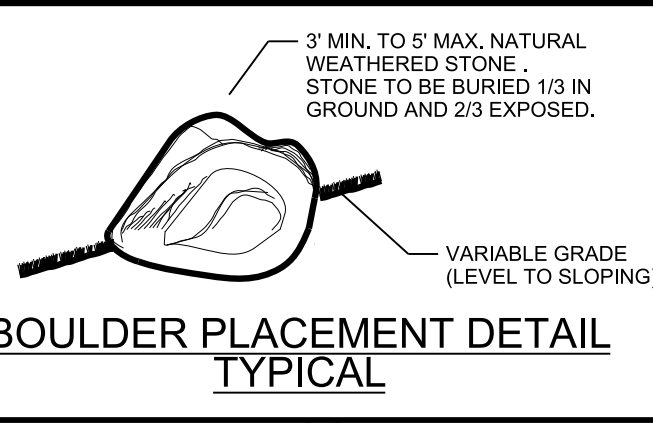
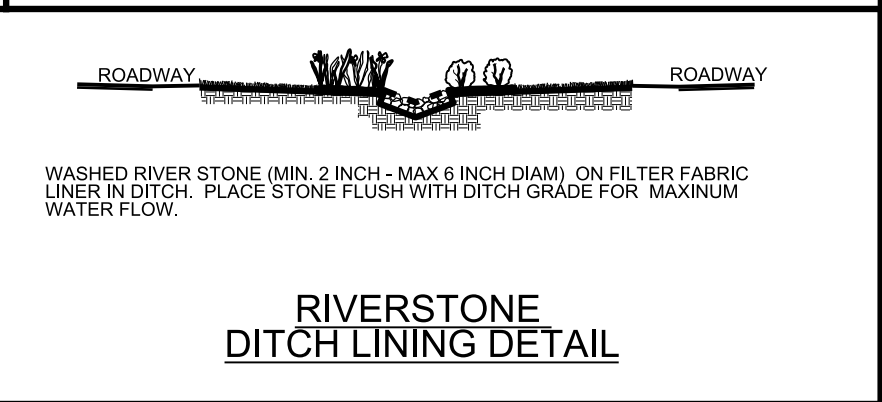
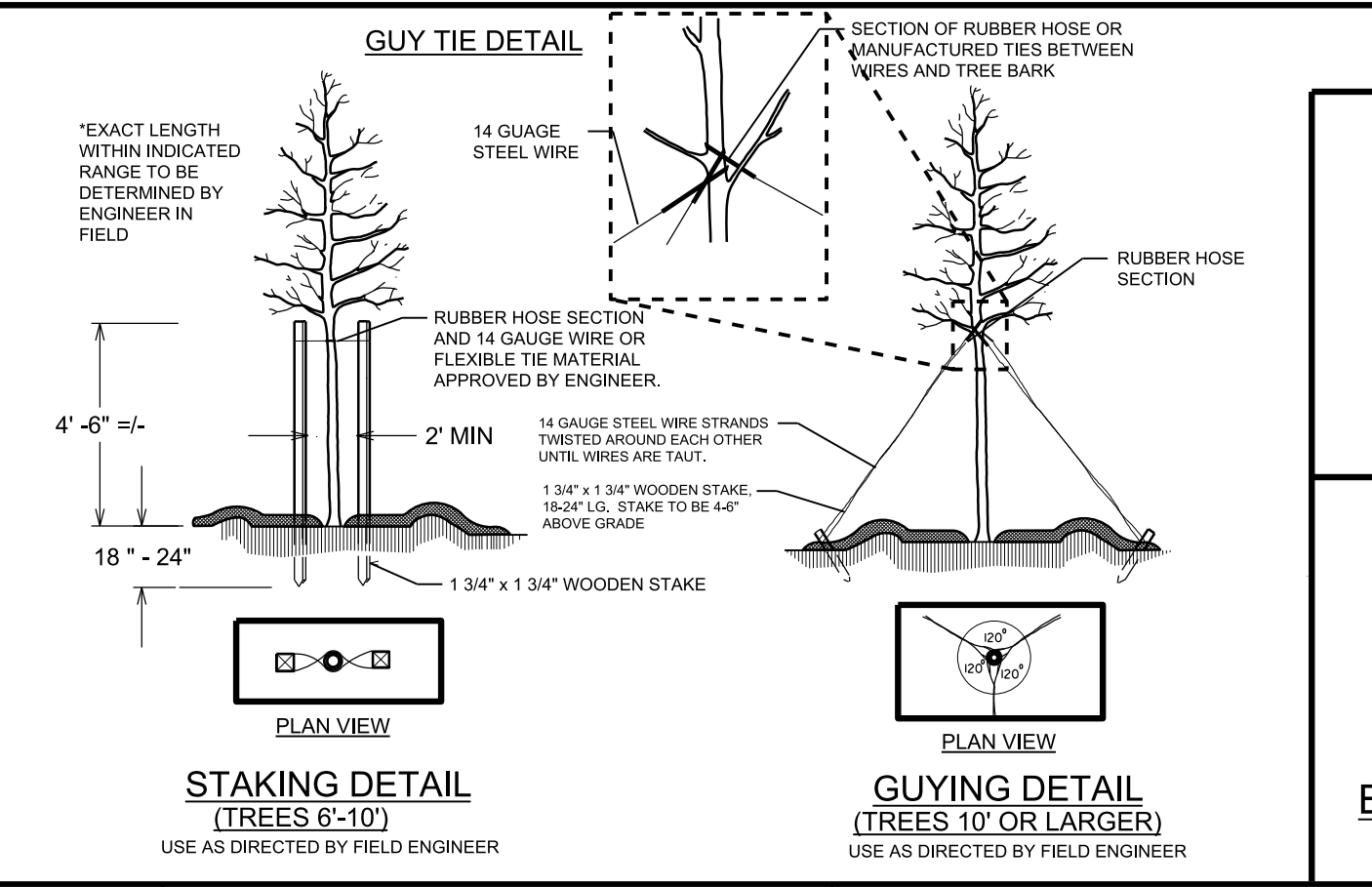

Landscape Development Plan

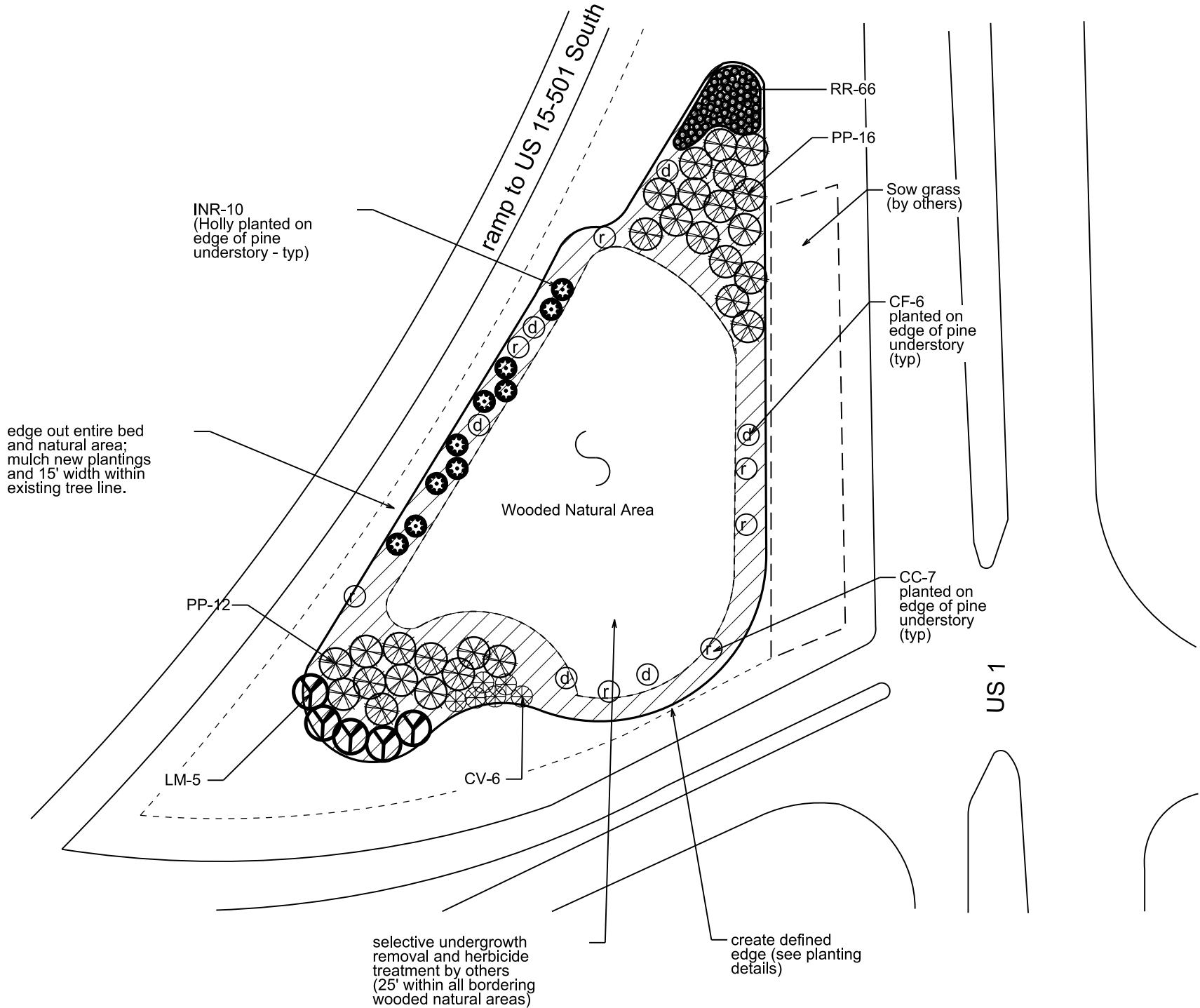

KEY	BOTANICAL NAME	COMMON NAME	FURNISH	REMARKS
Deciduous Trees				
OC	<i>Cercis canadensis</i>	E. Redbud	6' B & B	As Shown
CF	<i>Cornus florida</i>	Flowering Dogwood	6' B & B	As Shown
CV	<i>Chionanthus virginicus</i>	White Fringetree	6' B & B	As Shown
IF	<i>Ilex x attenuata 'Fosteri'</i>	Foster's Holly #2	6' B & B	As Shown
INR	<i>Ilex x 'Nellie R Stevens'</i>	Nellie R Stevens Holly	6' B & B	As Shown
LM	<i>Lagerstroemia indica 'Muskogee'</i>	Muskogee Crape Myrtle	10-12', B & B	Min. 2" Cal.
LP	<i>Lagerstroemia indica 'Potomac'</i>	Potomac Crape Myrtle	10-12', B & B	Min. 2" Cal.
PP	<i>Pinus palustris</i>	Long Leaf Pine	6-10', B & B	As Shown
PY	<i>Prunus x yedoensis 'Yoshino'</i>	Yoshino Cherry	10-12', B & B	As Shown
QN	<i>Quercus nuttallii</i>	Nuttall Oak	10-12', 2 1/2" cal. B & B	Min. 2" Cal.
Shrubs				
RR	<i>Rosa 'Radko'</i>	Del. Knockout Rose (Red)	15-18", #3 Cont.	3' O.C.
Ornamental Grasses and Perennial Plants				
MC	<i>Muhlenbergia capillaris</i>	Pink Muhly Grass	#1 Cont.	2' O.C.
PHM	<i>Panicum virgatum 'Heavy Metal'</i>	Heavy Metal Switchgrass	#1 Cont.	3' O.C.



27-SEP-2013 16:10 S:\ProjMgmt\Landscape_Contracts\33920.3.4_US15-501_MRFsigah_Lee Co\US 1-15501 split & MRFsigah plans.dgn jfrodor AT D8CAD-257160



ncdot - Roadside environmental unit
landscape design & Development
1557 mail service center raleigh nc 27699-1557
ph: 919-707-2920 fax: 919-715-2554
http://www.ncdot.org/doh/operations/dp_chief_eng/roadside/

Landscape Improvement Plan
Sanford - Lee County, NC
WBS # 3708.3.--

RN Kopetsky

prel. design date :	Sept/2013	US 1 & US 15-501 Split
checked by & date :		South of Tramway
final design date :	Oct/2013	landscape planting

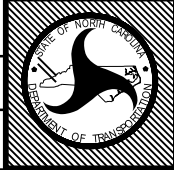

T.I.P. #	
WBS #	33920.3.4
FED I.D. #	
sheet no :	L3
total sheet no :	4

27-SEP-2013 16:10 S:\ProjMgmt\Landscapes\Contracts\33920.3.4_US15-501_MtPisgah_Lee Co\US 1-15501 split & Mt Pisgah plans.dgn jstoder AT DBCAD-257160

Renovation/ Plant Removal Plan

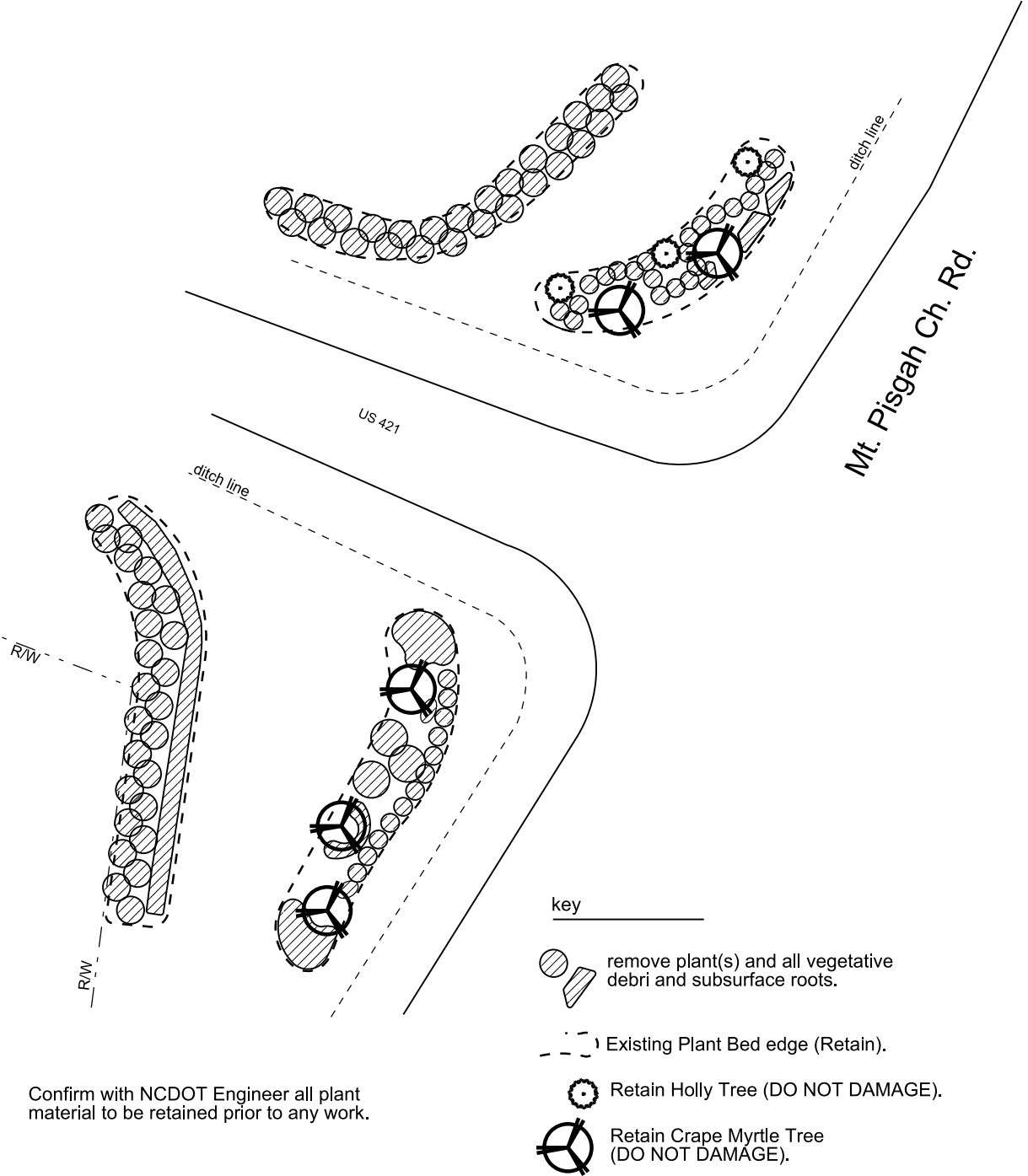

Renovation/ Landscape Plan

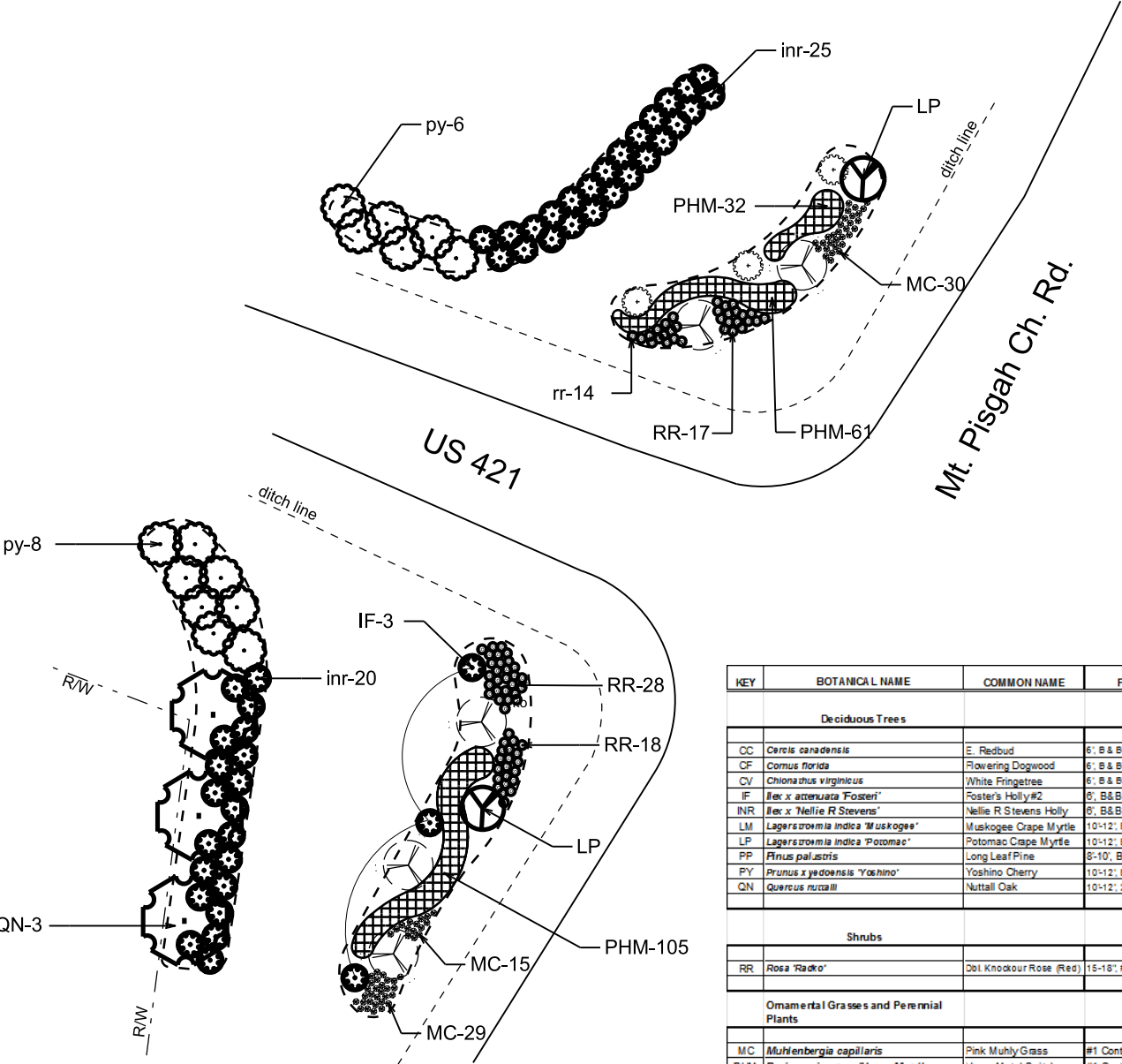

KEY	BOTANICAL NAME	COMMON NAME	FURNISH	REMARKS
Deciduous Trees				
CC	<i>Cercis canadensis</i>	E. Redbud	6' B & B	As Shown
CF	<i>Cornus florida</i>	Flowering Dogwood	6' B & B	As Shown
CV	<i>Chionanthus virginicus</i>	White Fringetree	6' B & B	As Shown
IF	<i>Ilex x attenuata 'Fosteri'</i>	Foster's Holly #2	6' B & B	As Shown
INR	<i>Ilex x 'Nellie R Stevens'</i>	Nellie R Stevens Holly	6' B & B	As Shown
LM	<i>Lagerstroemia indica 'Muskogee'</i>	Muskogee Crape Myrtle	10'12' B & B	Min. 2' Cal.
LP	<i>Lagerstroemia indica 'Pocomac'</i>	Potomac Crape Myrtle	10'12' B & B	Min. 2' Cal.
PP	<i>Pinus palustris</i>	Long Leaf Pine	8'10' B & B	As Shown
PY	<i>Prunus x yedoensis 'Yoshino'</i>	Yoshino Cherry	10'12' B & B	As Shown
QN	<i>Quercus rupestris</i>	Nuttall Oak	10'12' 2 1/2" cal. B & B	Min. 2' Cal.
Shrubs				
RR	<i>Rosa 'Radco'</i>	Dbt. Knockout Rose (Red)	15-18" #3 Cont.	3' O.C.
Ornamental Grasses and Perennial Plants				
MC	<i>Muhlenbergia capillaris</i>	Pink Muhly Grass	#1 Cont.	2' O.C.
PHM	<i>Panicum virgatum 'Heavy Metal'</i>	Heavy Metal Switchgrass	#1 Cont.	3' O.C.

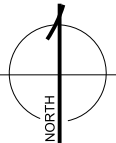

ncdot - Roadside environmental unit
landscape design & Development
1557 mail service center raleigh nc 27699-1557
ph: 919-707-2920 fax: 919-715-2554
http://www.ncdot.org/doh/operations/dp_chief_eng/roadside/

Landscape Improvement Plan
Sanford - Lee County, NC
WBS # 3708.3.--

RN Kopetsky

sheet description:	prel. design date :	Sept/2013	US 421 @ Mt. Pisgah Ch. Rd.
	checked by & date :		landscape planting
	final design date :	Oct/2013	

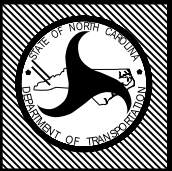

T.I.P. #	
WBS #	33920.3.4
FED I.D. #	
sheet no :	total sheet no :
L4	4